

► EF 4

► EF 2

► EF 0.1



► Based on the same meshing gear principle as the VSE series VS and VHM the Ecoflow sensor measures viscous media, however as in-line-device.

► An integrated, magnetoresistive pick-up with pnp or npn-switching output produces per tooth one impulse with a worth of 0.1 cc for the size EF0.1 and 2 cc for the size EF2. The impulse frequency is proportional to the revolutions of the gear wheels, which are driven by the volume stream.

► The impulse processing is made by means of VSE-made or any other electronic readout.

► The Ecoflow is a low-priced alternative to the VS series for application with lower requirements to the technical qualities such as accuracy, pressure, temperature, etc.

The issue of this catalogue invalidates all specifications in earlier publications. Changes and deviations are reserved by VSE. VSE will not accept liability for printing errors. Reproduction, including excerpts, is only permitted with written permission by VSE. Revision: 08/2001





## ► EF 0.1

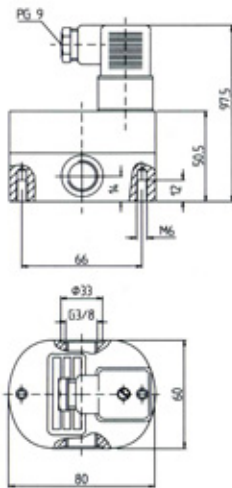

## ► EF 2

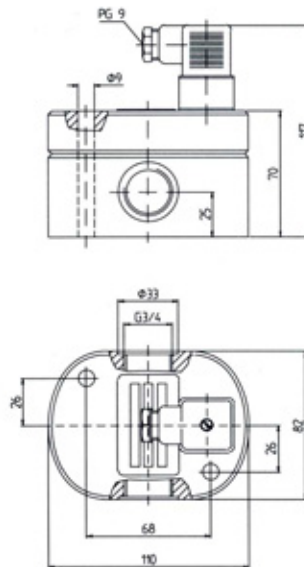

## ► EF 4

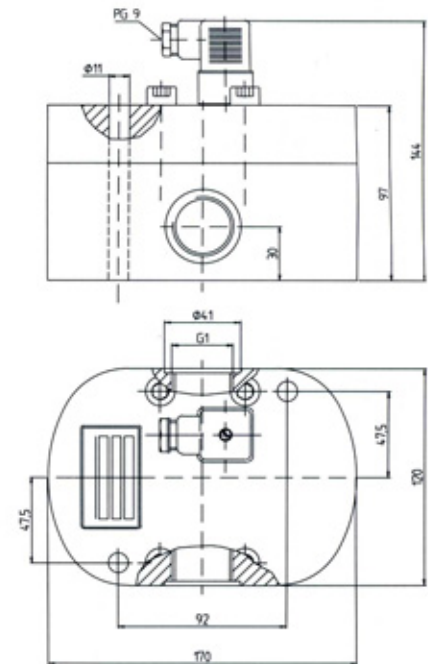

## ► Pick-up Output Signal

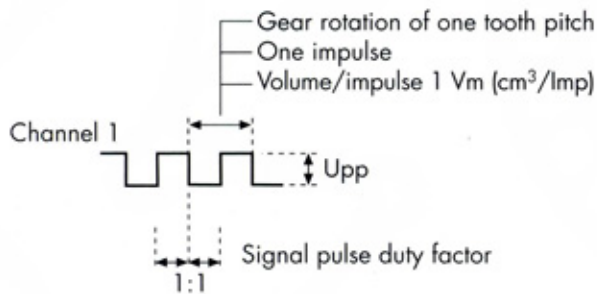

## ► Cable connection Flowmeter to Pulse-Processor

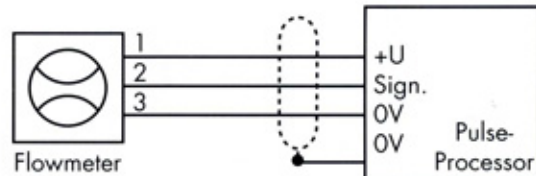

- 1. Power Supply: 10...30 V DC
- 2. Signal Output: NPN or PNP
- 3. Power Supply: 0 V

## ► Plug connection diagram

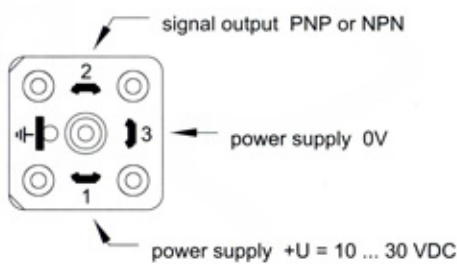

## ► Flowmeter Signal Output

Output:  
NPN-Signal

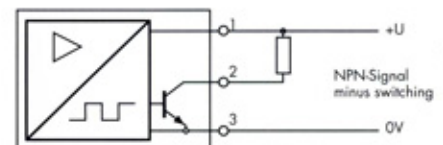

Output:  
PNP-Signal

